

**101294160 EL.SPER.AS 1875 40050**

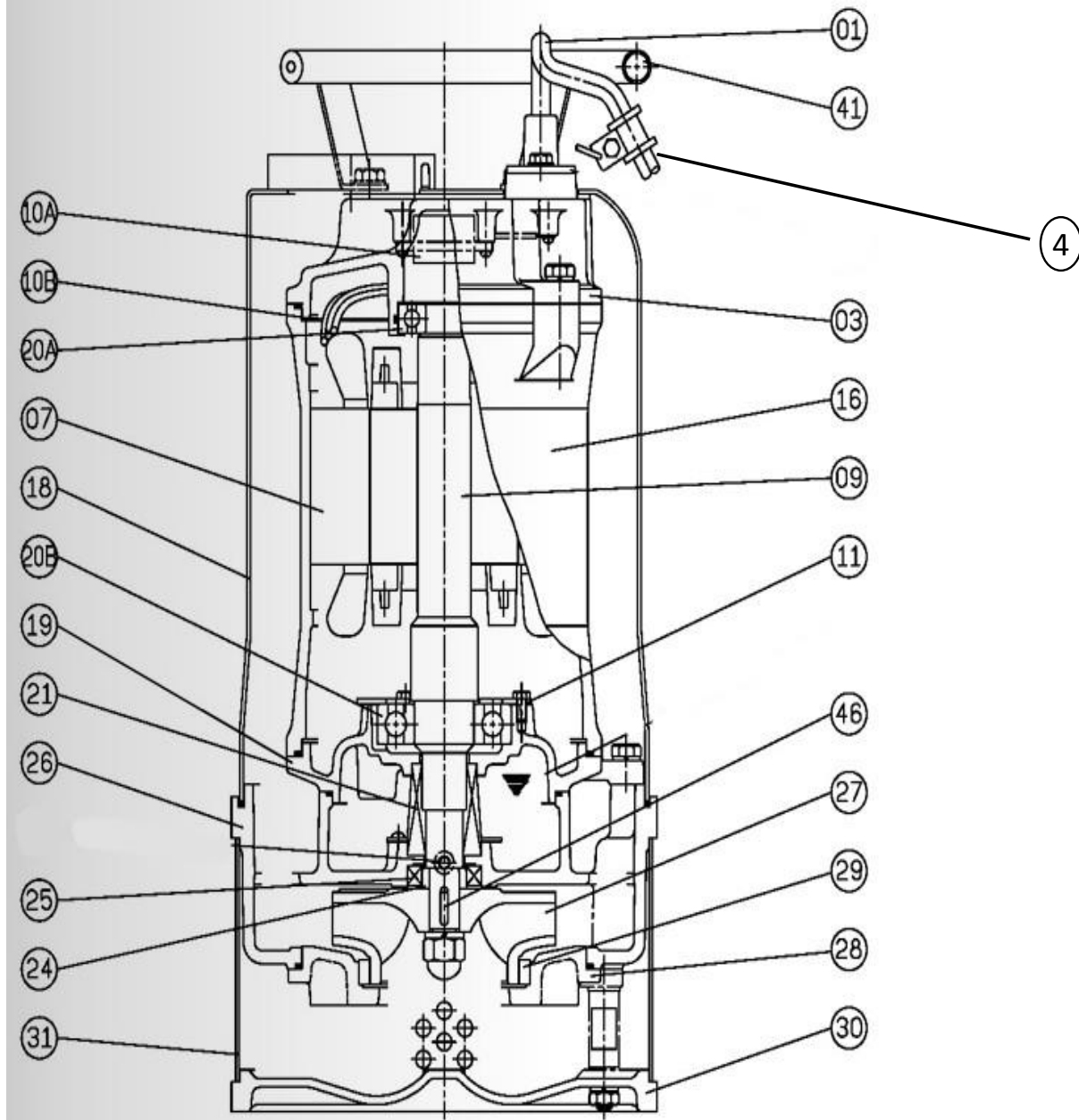

No.	Code	Description	Qt	No.	Code	Description	Qt
1	HC80ASH255.01	Cavo - Cable	1	24	HC80ASH255.24	Boccola tenuta olio - Oil seal bush	1
3	HC80ASH255.03	Coperchio superiore - Upper cover	1	25	HC80ASH255.25	Corteco - Oil seal	1
7	HC80ASH255.07	Statore - Stator 3/400/50	1	26	HC80ASH255.26	Corpo pompa - Pump body	1
9	HC80ASH255.09	Albero con rotore - Shaft(with Rotor)	1	27	HC100ASN.255.27	Girante - Impeller	1
10A	HC80ASH255.10	Auto-cut	1	28	HC100ASN.255.28	Coperchio corpo pompa - Casing cover	1
10B	HC80ASH255.10B	Auto-cut plate	1	29	HC100ASN255.29	Anello - Wear ring	1
11	HCF32TU.11	Bearing Fixer	1	30	HC80ASH255.30	Base - Footing	1
16	HC80ASH255.13	Cilindro motore - Motor frame	1	31	HC80ASH255.31	Griglia - Strainer	1
18	HC80ASH255.18	Corpo esterno - Out cover	1	41	HC80ASH255.41	Maniglia - Handle	1
19	HC80ASH255.19	Staffa cuscinetto - Bearing bracket	1	46	HC80ASH255.46	Linguetta - Key	1
20A	HCF32TU.20B	Cuscinetto superiore - Upper bearing	1	47	HC80ASH255.47	Imballo - Packing(1 set)	1
20B	HC80ASH255.20B	Cuscinetto inferiore - Lower bearing	1	4	HC80ASH255.04	Cable base cover	1
21	HC80ASH255.21	tenuta meccanica - Mechanical seal	1				